

Access to Virtual EREL

1. Open the zoom software in your computer

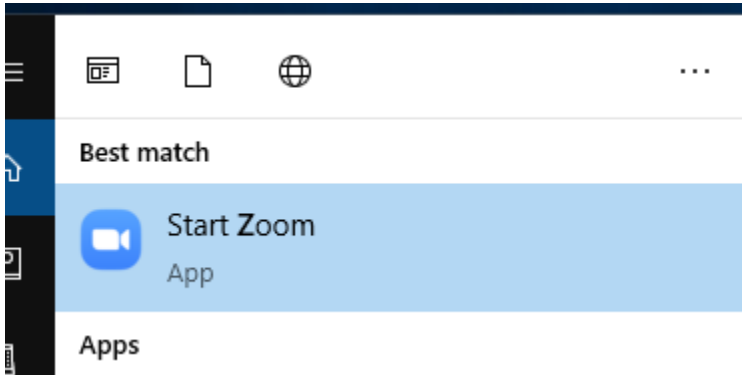

2. Click on the **Contacts**

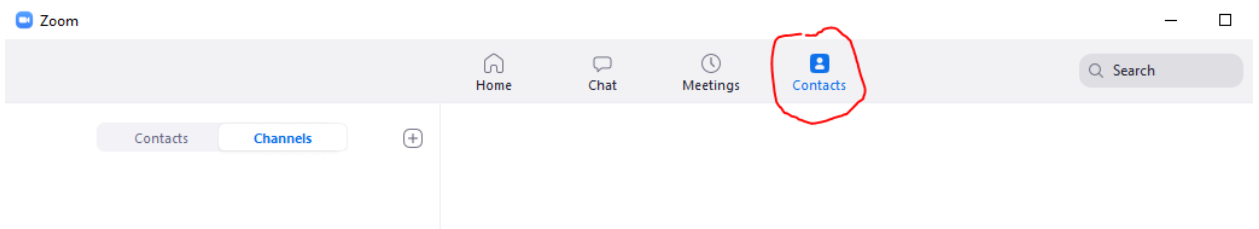

3. Click on the +

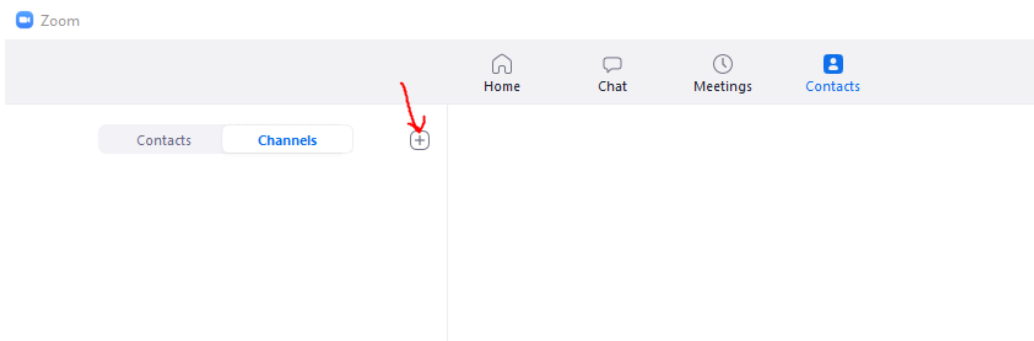

4. Select **Join a Channel**

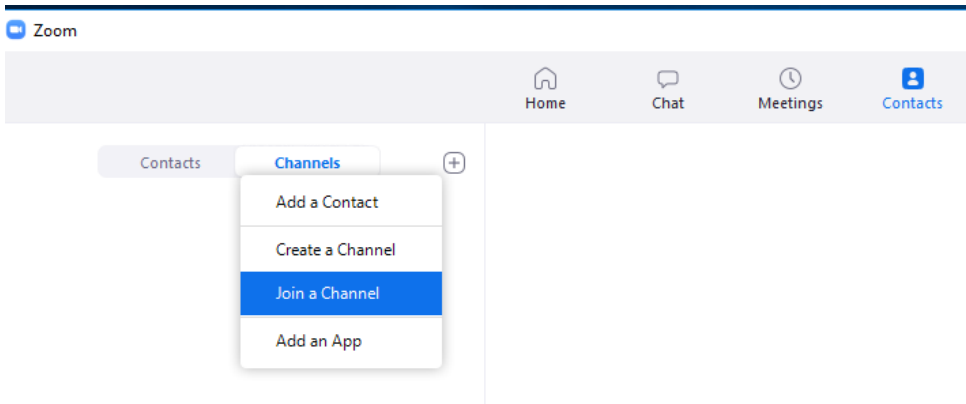

5. Type in "EREL Virtual Assistance"

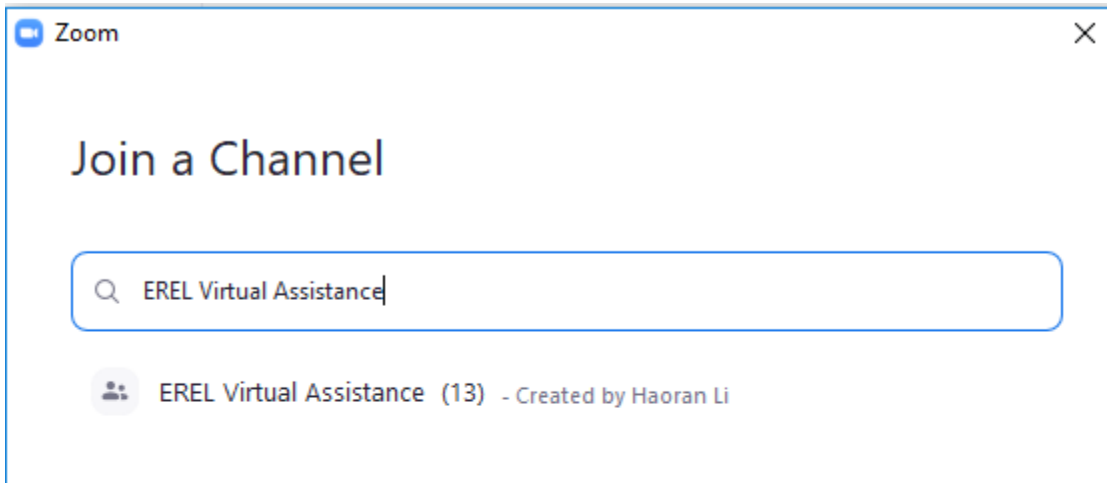

6. Click the **join**

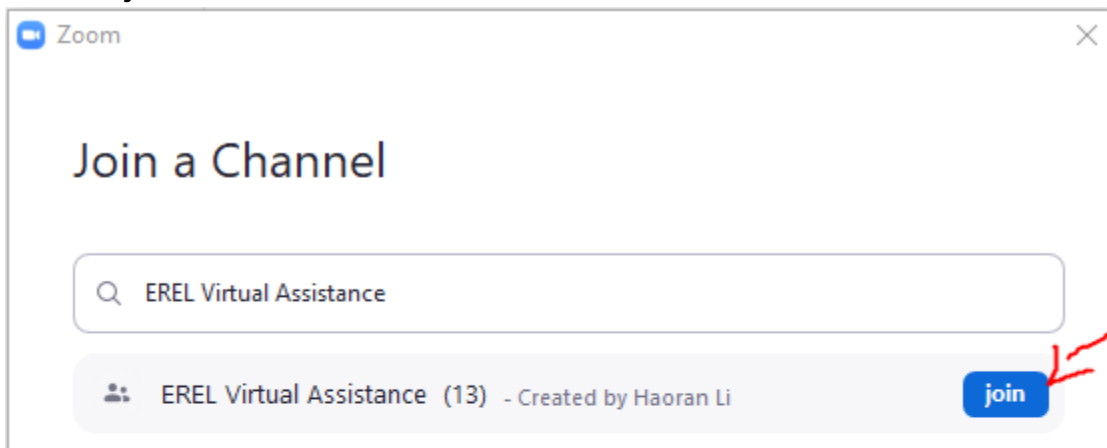

7. At this point you should be able to join the channel.

8. Once you joined the channel, you can access the channel by clicking **Chat**

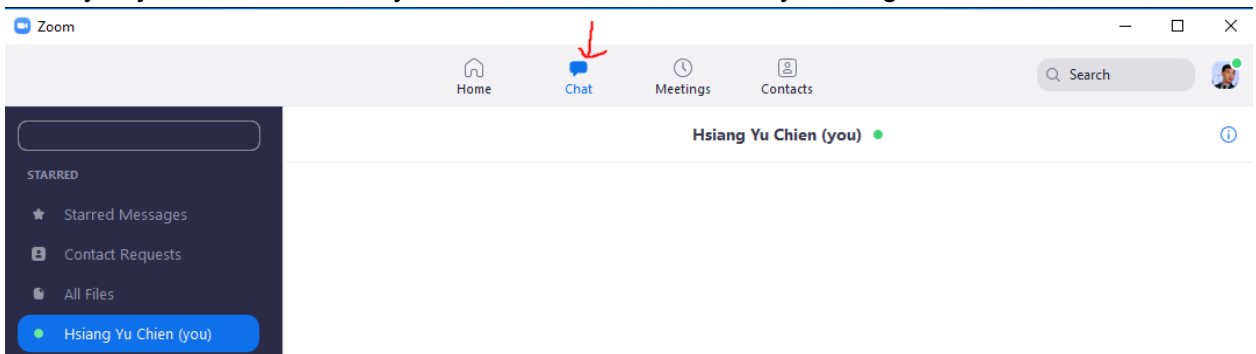

9. The EREL Virtual Assistance could be found on the left side

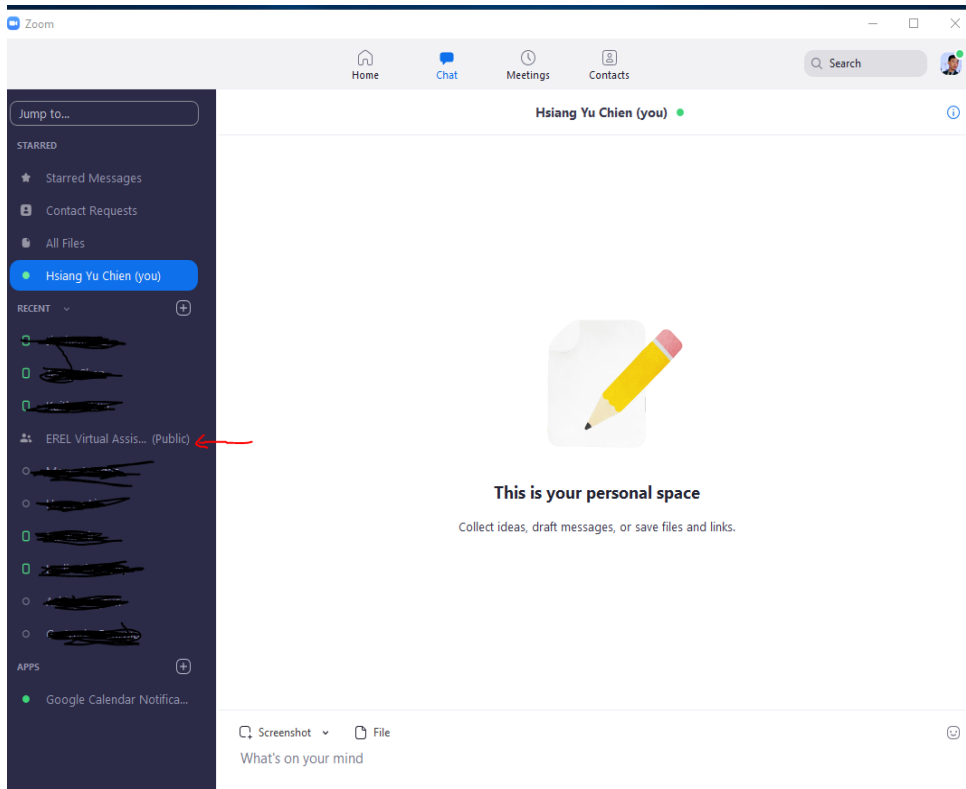

10. If you cannot find it, go to **Jump to...** search **EREL Virtual Assistance**

